

Todos los conectores son de ENP (niquelado electrolítico)

### Macho #10-32 a espiga

(paquete de 5 unidades)

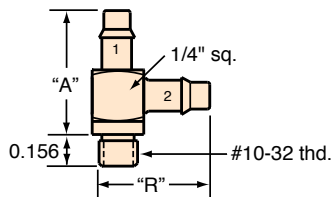

Espiga 1 (D.I.)	Espiga 2 (D.I.)	No. de parte	"A"	"R"
1/16"	1/16"	TT2-2	0.515"	0.460"
1/16"	1/8"	TT2-4	0.500"	0.525"
3/32"	3/32"	TT3-3	0.543"	0.493"
1/8"	1/16"	TT4-2	0.593"	0.460"
1/8"	1/8"	TT4-4	0.593"	0.538"

Junta de nitrilo incluida, no instalada

### Macho #10-32 a espiga giratoria

(paquete de 5 unidades)

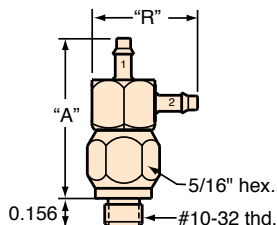

Espiga 1 (D.I.)	Espiga 2 (D.I.)	No. de parte	"A"	"R"
1/16"	1/16"	ST2-2	0.781"	0.516"
3/32"	3/32"	ST3-3	0.821"	0.556"
1/8"	1/8"	ST4-4	0.872"	0.556"

Junta de nitrilo incluida, no instalada

### Universal #10-32 a espiga

(paquete de 5 unidades)

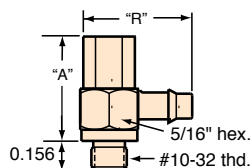

Espiga (D.I.)	No. de parte	"A"	"R"
1/16"	UTF-2	0.562"	0.504"
3/32"	UTF-3	0.562"	0.556"
1/8"	UTF-4	0.562"	0.576"

Se incluye un o-ring de nitrilo

### Universal #10-32

(paquete de 5 unidades)

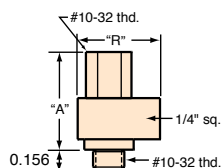

No. de parte	"A"	"R"
UTF-F	0.562"	0.500"

### Macho 1/8 NPT a espiga

(paquete de 5 unidades)

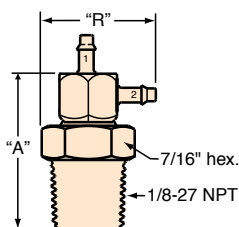

Espiga (D.I.)	No. de parte	"A"	"R"
1/16"	SP2-2	1.031"	0.625"
3/32"	SP3-3	0.656"	1.062"
1/8"	SP4-4	1.156"	0.718"

### Espiga a espiga giratoria

(paquete de 5 unidades)

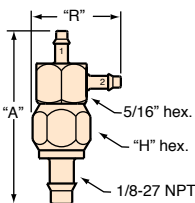

Espiga 1 (D.I.)	Espiga 2 (D.I.)	No. de parte	"A"	"R"
1/16"	1/16"	S42-2	1.074"	0.531"
1/8"	1/8"	S44-4	1.183"	0.611"

